

# Hawkins Rejuvenation - 2 to 8 Bucklersbury, Hitchin

Consultation Event

The redevelopment of 2-8 Bucklersbury aims to rejuvenate this historic streetscape at the heart of Hitchin. The proposal brings new commercial spaces to the street and transforms the un-used office spaces above the former Hawkins Department Store into eight new homes, interweaving with the historic form of Bucklersbury.

Cooley Architects, on behalf of AdenRock, welcome this opportunity to gain public feedback on the proposal for the development, prior to submission of a planning application to North Hertfordshire Council.

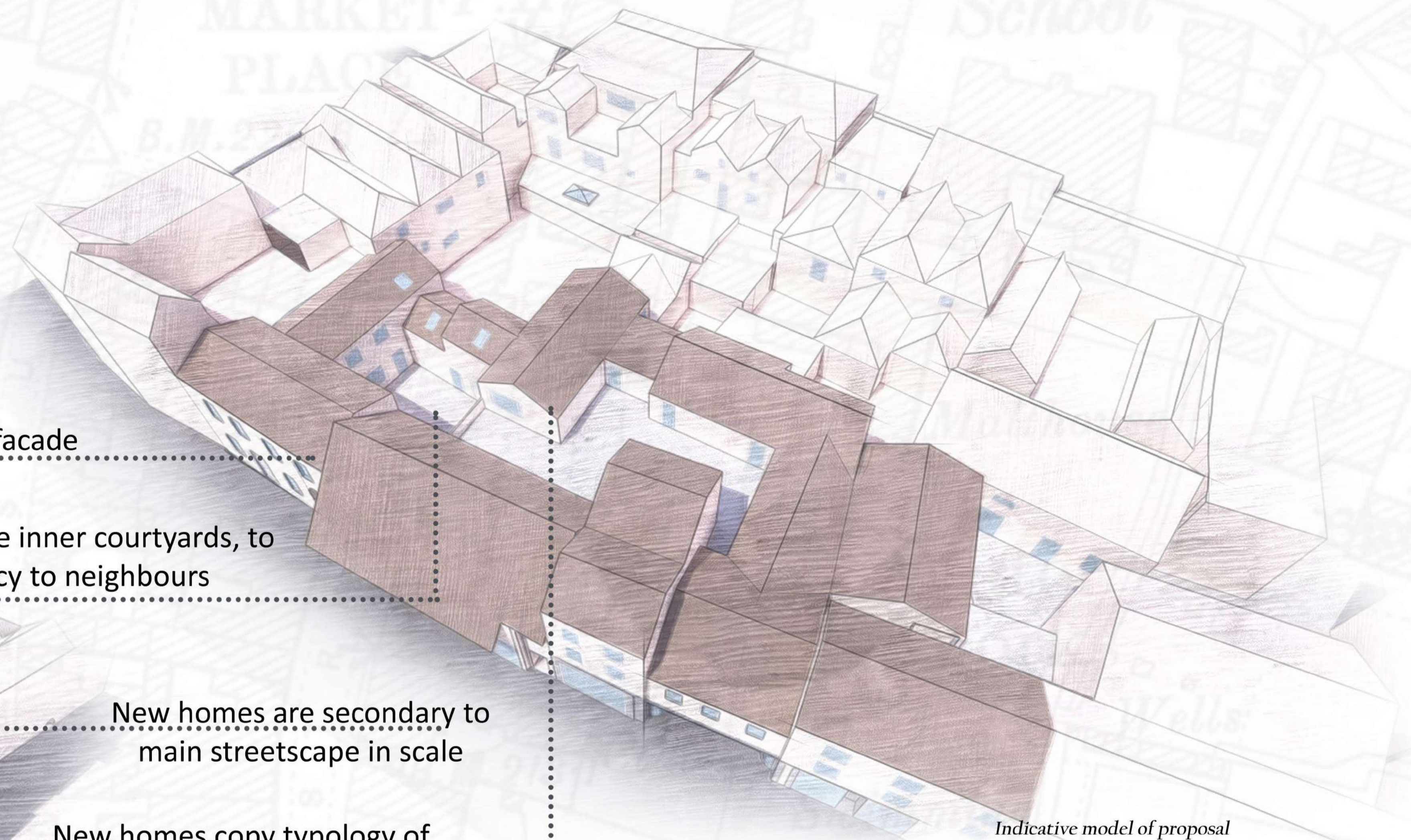

Indicative model of proposal

Rejuvenated historical street facade

New homes face inner courtyards, to keep privacy to neighbours

New homes are secondary to main streetscape in scale

New homes copy typology of the existing

Reinstated historic facade at no.7

Reinstated historic carriage arch at no.2

New Commercial spaces along Bucklersbury

Indicative model of proposal



Historical Map of Bucklersbury, Hitchin